

- GENERAL NOTES**
- All work indicated on these plans shall be in conformity with applicable provisions of the Standard Specifications for Road and Bridge Construction, No. 2271 and Standard Drawing No. 2271.
 - Process Curb for driveways where necessary. Locations of curbs to be determined by the contractor.
 - Block Mark EL 1225.51 at S.E. Corner East Corner Sierra Hwy and Thirtieth St.
 - U.S.G.S. 49 564
 - Removal of Obstructions:
 - * To be removed under this contract
 - * To be removed and replaced by other

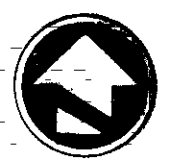

PLAN
Scale 1"=40'

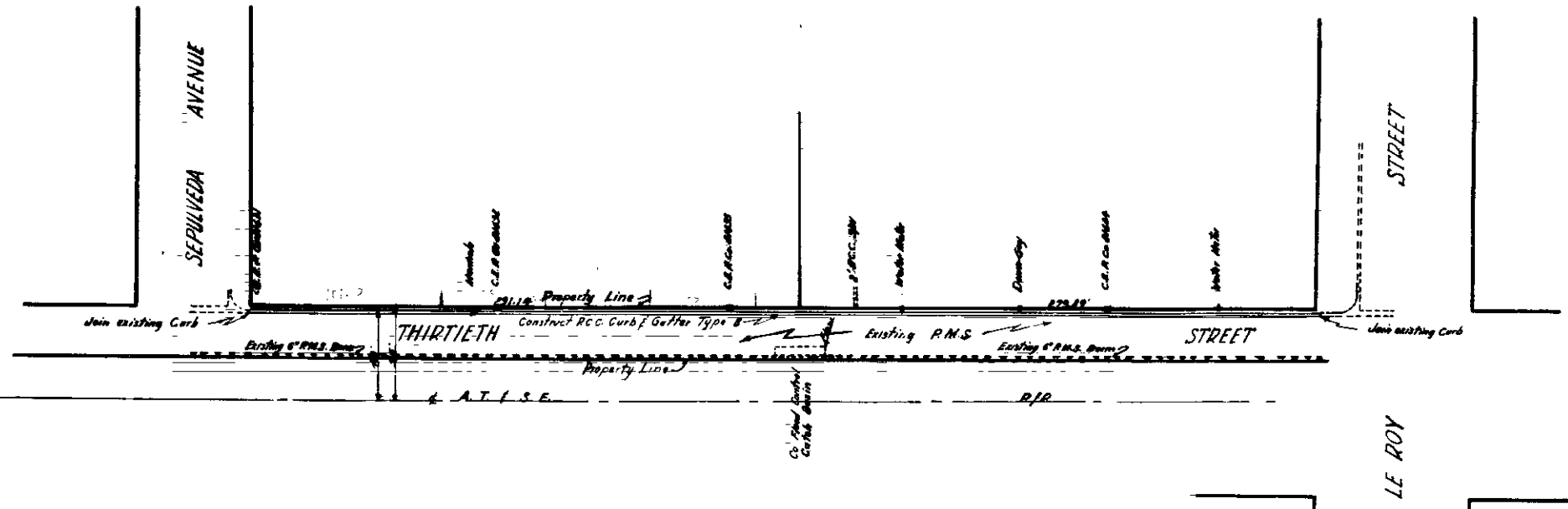

DEPARTMENT OF ENGINEERING
CITY OF SAN BERNARDINO
THIRTIETH STREET
Between Sepulveda Avenue and Le Roy Street
(CURB & GUTTER)

SUBMITTED BY _____ REFERENCE _____
APPROVED BY _____ DATE MAY 14, 1937 DRAWN BY _____